



GIVE A Charles Van Damme

SAVE. RESTORE. EXHIBIT

The 1916 Paddlewheel & Smokestack

The Charles Van Damme Ferry Project's mission is to celebrate the lively history of the Sausalito waterfront by exhibiting the vessel's original paddle wheel and the smokestack. This important permanent display will be located in the new Waldo Point Park, where the ferryboat last stood. The exhibit will serve as an educational and inspirational display of the rich maritime and artistic culture of Sausalito's exuberant past.

The Charles Van Damme Ferry has the distinction of being a unique axis for the San Francisco Bay's colorful history. Built in 1916, she was a ferryboat for forty years, bringing passengers, cars, cattle, and provisions to many Bay Area communities. After her transport service ended, the Charles Van Damme continued in other storied incarnations, gathering together a whole new community that celebrated music, the visual arts -- and even fine food.

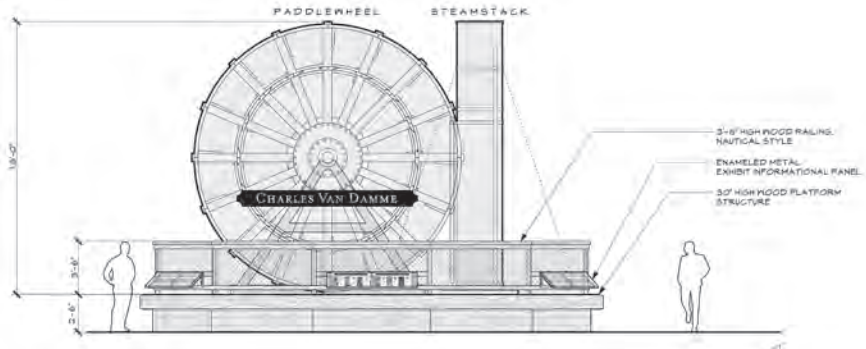

For the past eleven years we have worked to revive her history by creating an educational display of her iconic paddlewheel and smokestack. We believe this project is vitally important to Sausalito's ongoing effort to recognize the boat builders, seamen, artists, musicians, dancers, and craftspeople that worked on -- and lived on -- this great ship.

We have secured and stored the wheel, stack and artifacts, we have a dedicated location, architectural & engineering plans and have acquired all the planning and building permits required.

Our committee of eight members meets regularly at the offices of Michael Rex, our architect. We have embarked on major a yearlong fundraising effort to fund the construction of the display.

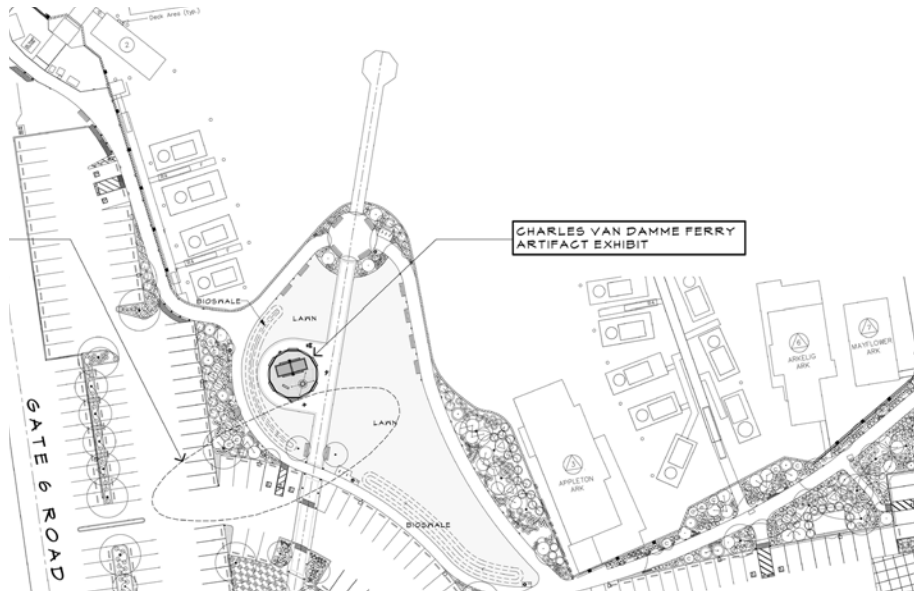

With the donation of your time, money, expertise and support we will succeed in saving, restoring and displaying a rare and important local maritime and cultural icon to inspire both present and future generations to come.

We are under the umbrella of The Richardson's Bay Maritime Association (RBMA) non profit 501(3)c

Visit www.charlesvandammeferry.org,
To learn more



March 12 2021



THE 9 LIVES OF THE CHARLES VAN DAMME FERRY – A UNIQUE SAUSALITO STORY

The Charles Van Damme Ferry is a unique axis in the San Francisco Bay's colorful history. Built in 1916, she was a ferryboat for forty years, bringing passengers, cars, cattle, and provisions to Bay Area communities. After her transport service ended, the Charles Van Damme continued in another storied incarnation on the Sausalito waterfront, bringing together a whole new generation, celebrating the arts, music and food.

From 1940 through the '80's the Van Damme was the "town hall" for artists of all stripes. The Charles Van Damme housed the Ark Nightclub in the late '60's, featuring many of the emerging rock bands, acts included Janis Joplin, Bob Dylan and Santana.



Juanita Musson launched her legendary Juanita's restaurant there, feeding rich and poor and stirring up controversy galore. Writers, painters, poets, sculptors, dancers and musicians moved to the Sausalito waterfront houseboat community looking to live and create alongside and on the great old beached Ferry.

Thirty-five years ago, 1983, the boat had become badly deteriorated and was demolished by order of Marin County. But through the determined efforts of local citizens, the original paddle wheel, smokestack and other artifacts were saved.

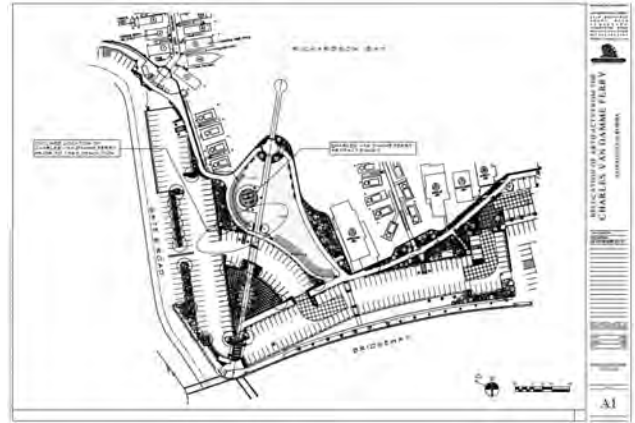

Our group, the Charles Van Damme Ferry Project, a sub-committee of our non-profit sponsor, The Richardson's Bay Maritime Association (RBMA), is now embarking on the final phases of our effort to create a public home for the vessel's paddle wheel and smokestack. This permanent display will be located where the ferryboat last stood at Gate 5 Road in the new Waldo Point Harbor park in Sausalito. Surrounding the display will be signage depicting the Charles Van Damme's unique history, serving as an inspiration to a new generation of fans of maritime and artistic culture.

We have secured and stored the wheel and stack. We have an approved location, detailed architectural plans and acceptable bids from skilled builders. With the broad support of area officials, we have obtained from the County of Marin a Building Permit for construction. With these accomplishments now firmly in place, our committee, led by the architect for the project, Michael Rex, has begun a rigorous fundraising effort to fund the construction of the display.

We estimate the cost of our Charles Van Damme Ferry Project at approximately three hundred and fifty thousand dollars. We are raising funds and securing volunteer services simultaneously, offsetting the cash requirements with donated materials and labor.

The location of the landmark will be Waldo Point Harbor, one of the most famous houseboat communities in the world. Even now, with little public or tour bus parking, hundreds of people come every day to see the unique and colorful Sausalito houseboats they have heard so much about.

The Charles Van Damme Ferry Exhibit will furnish another important piece of Sausalito's history for local residents and visitors. Reminding all of us of our unique city and surrounding area, it will pay respect to a bygone maritime era and the ongoing waterfront life surrounding the arts and creative pursuits.



By celebrating this hub of transport and creativity, we will encourage residents and visitors to continue the fantastic creative spirit of the Sausalito waterfront. The Charles Van Damme Ferry once again will serve as an important cultural icon.

We hope you will join us in supporting this exciting project!

We are under the umbrella of The Richardson's Bay Maritime Association (RBMA), a non-profit 501(c)(3). For more information about the Ferryboat and this community restoration effort, please visit our website at: <https://www.charlesvandammeferry.org>

For the whole story, you can go to this link: https://www.charlesvandammeferry.org/uploads/6/8/6/1/686169/update_cvd_booklet_aug_8th_2013_web.pdf

Sincerely,

Michael Rex, Architect
Chair of the Richardson's Bay Maritime Association